

SPECIFICATIONS

- Speaker unit

Output level	83dB
Rated input Power	0.5W
Max. input Power	1W
Impedance	8Ω

- Microphone unit

Type of element	Electret-condenser
Sensitivity	-58dB
Impedance	2kΩ

OPERATION

1. Connect the SMC-34 to the MIC-SP jack of the transceiver.
2. Set the Volume control of the SMC-34 to maximum position.
3. Adjust the Volume control of the transceiver and then adjust the SMC-34 Volume control.

If you want to operate the programmable function(function keys), refer to the instruction manual provided with the transceiver.

(Section: Programming the Remote Control Speaker microphone)

SMC-34

EXPLODED VIEW

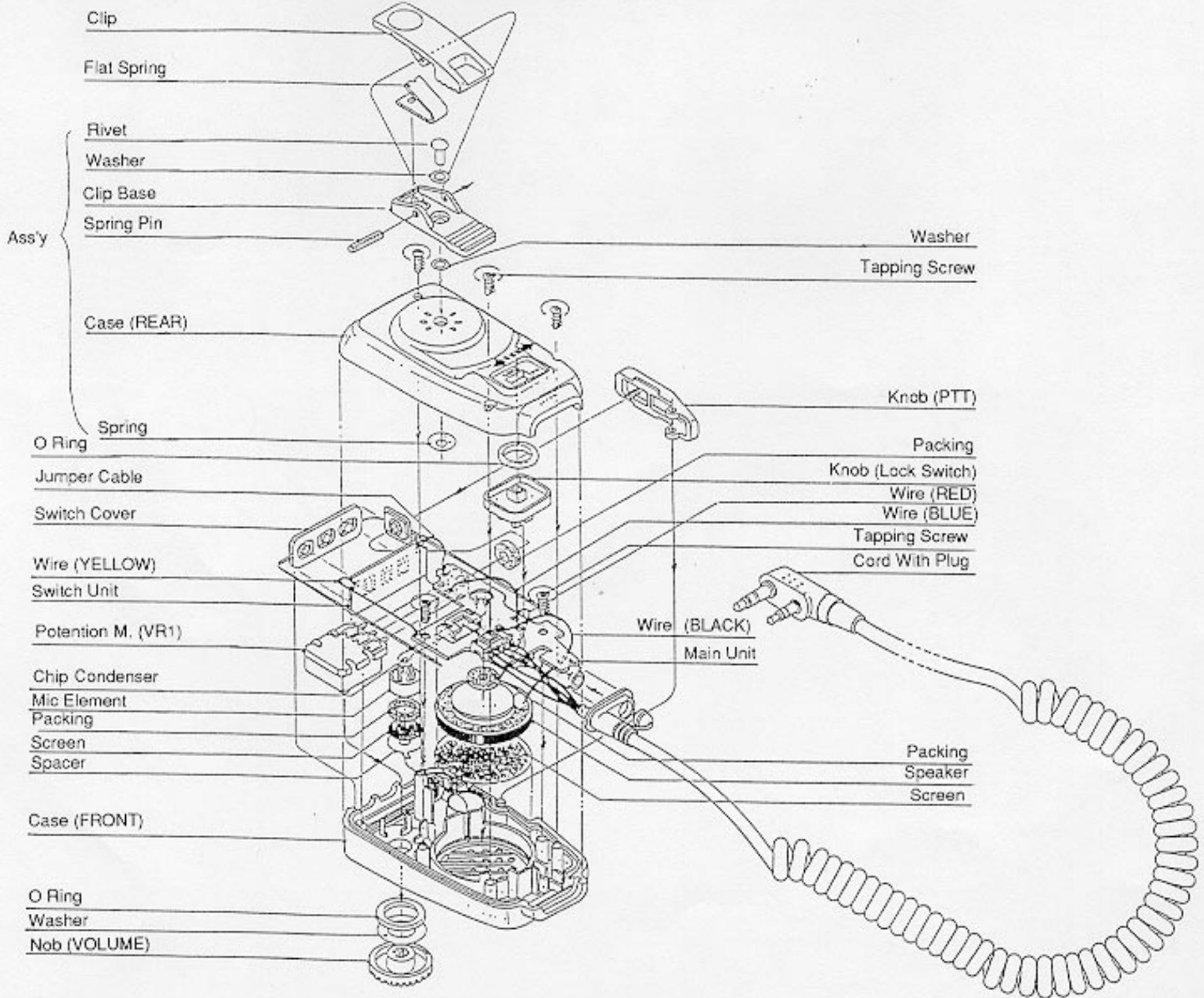

CARL CORD

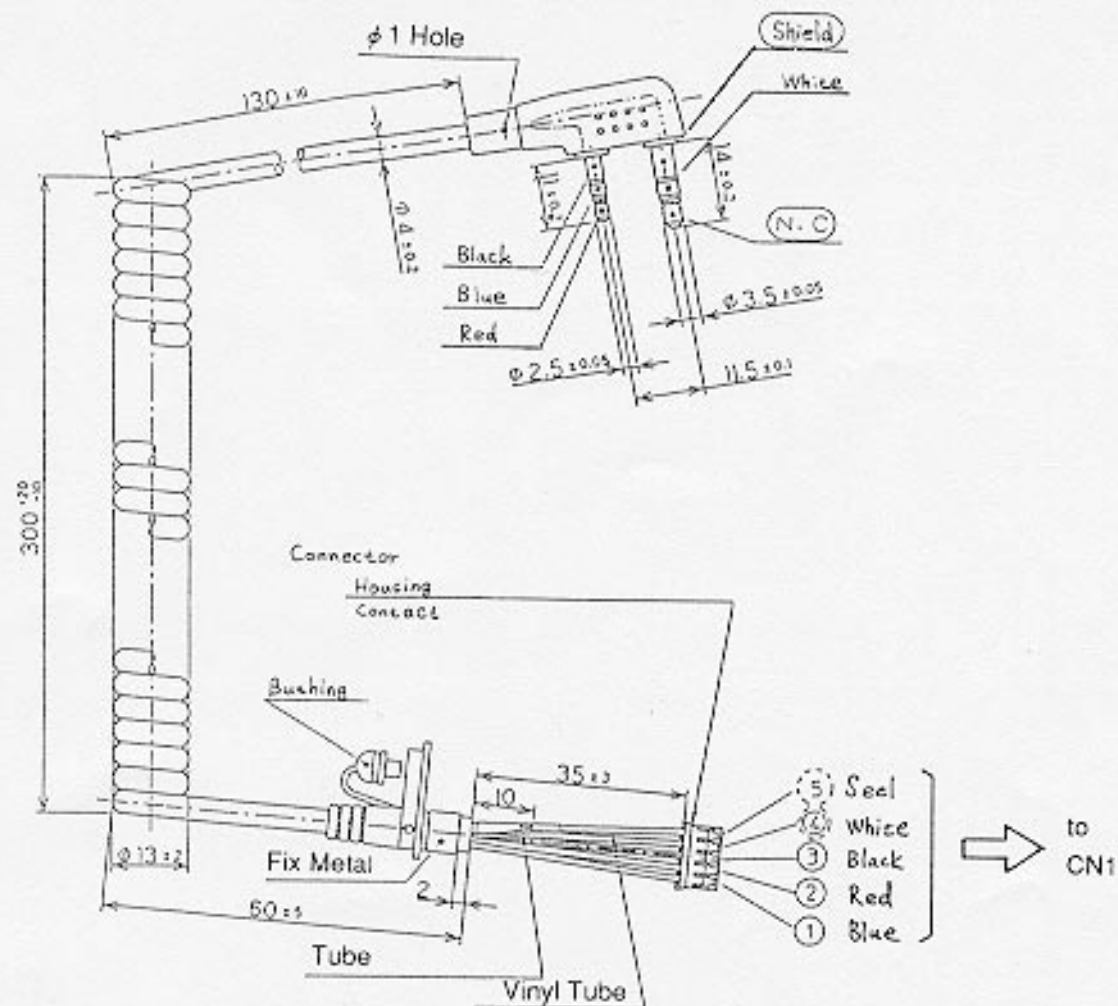

SCHEMATIC DIAGRAM

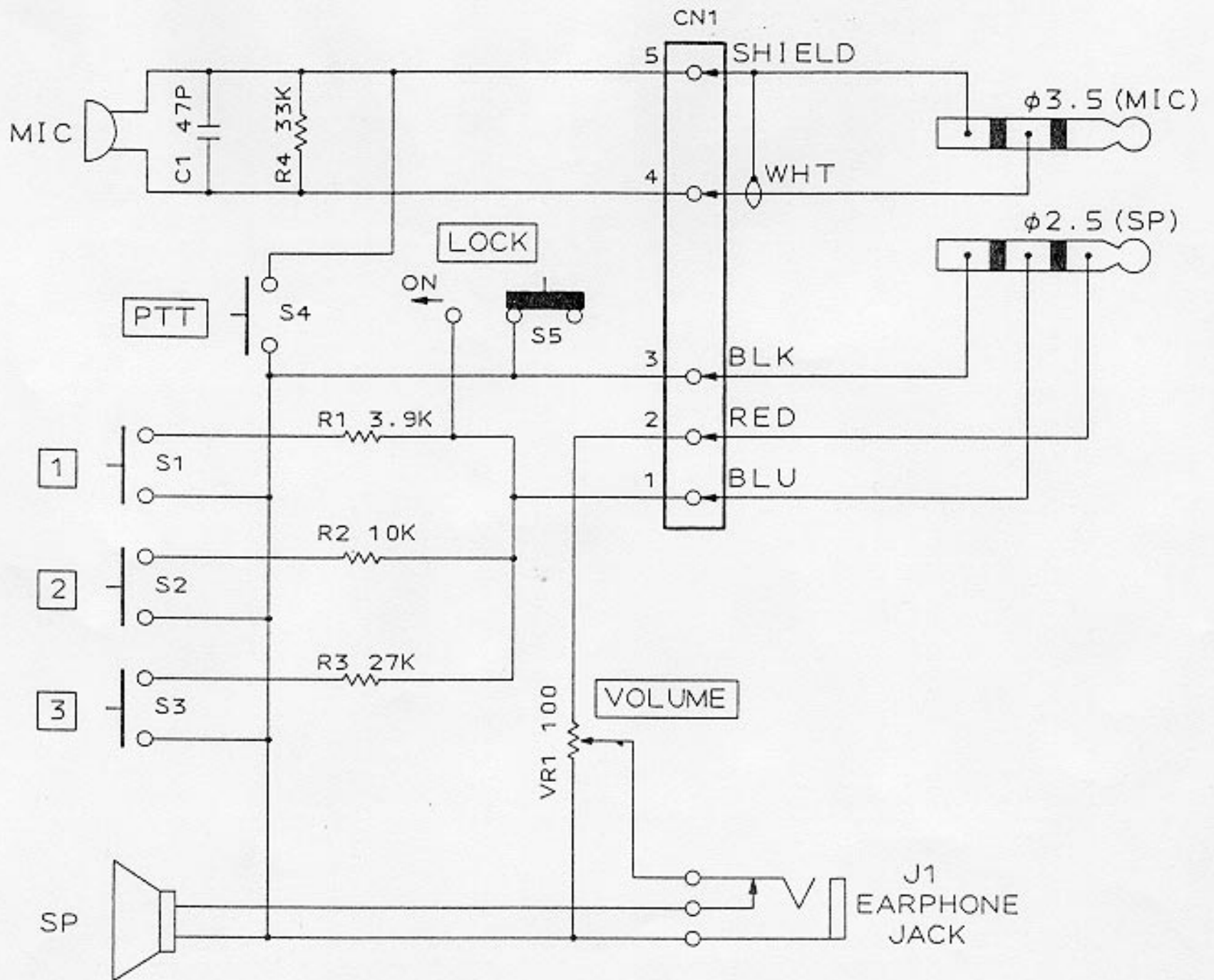

PC BOARD

